

The Official MIUI V5 User Guide

A note about flashing MIUI on to your device

The process for flashing MIUI varies a bit depending on what device you're using. If you have a Xiaomi device, the guys over at Xiaomi.eu (aka MIUI Android) have written a great series of guides about flashing ROMs on to Xiaomi devices.

If you have another Android device, don't worry, the process is pretty straight forward. XDA has a wiki guide on how to flash ROMs on to Android devices.

You can always find the latest official build on the English MIUI home page.

Getting started

Ok, just so we're all on the same page: At this point the hard part is over, you've installed MIUI and you've powered on your device. Select your preferred language at the welcome screen (i.e. the first screen you see after turning on your device) (left). On the following screen (right), you can select a wireless network to connect to (Tip: using Wi-fi networks when ever possible will reduce your mobile data usage).



After you've successfully connected to a wireless network, touch Next to go to the SIM card configuration screen. If you haven't inserted a SIM card (or have inserted the SIM card incorrectly) you can either Power off your phone if you want to insert one or Continue if you want to skip this step.

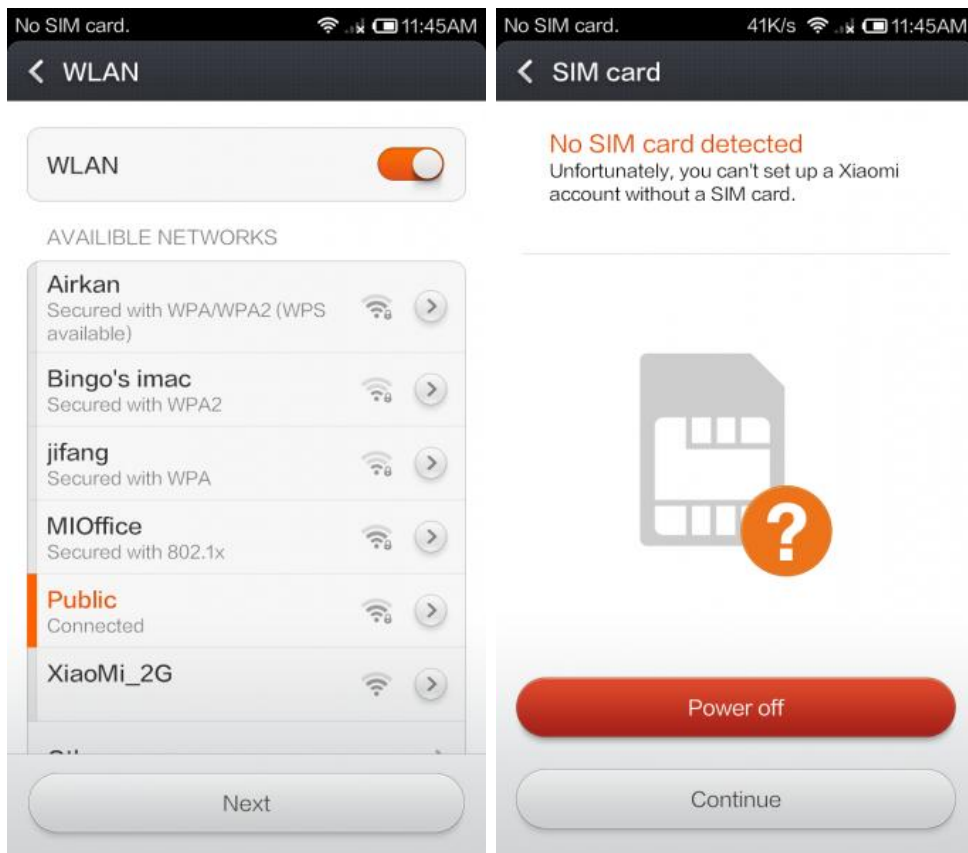

Next (if a SIM card is detected) you'll come to the Xiaomi account set up page (if you haven't inserted your SIM card, don't worry, you can set up an account later in Settings). Using a Xiaomi account enables you to enjoy the best of MIUI: Get up to 10GB of free storage on MiCloud, sync messages and contacts across devices, share photos, and back up your phone's user data. Xiaomi accounts are completely free (your service provider's regular mobile data charges may apply). You can register using your phone number or your email address.

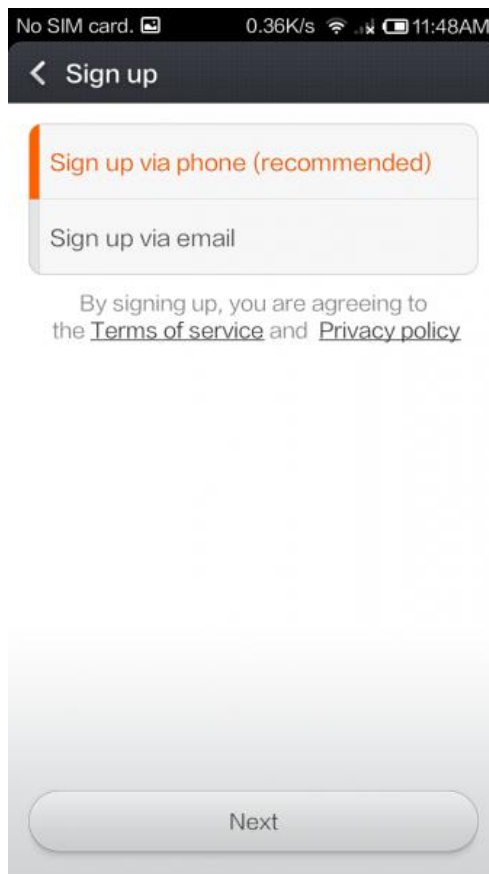
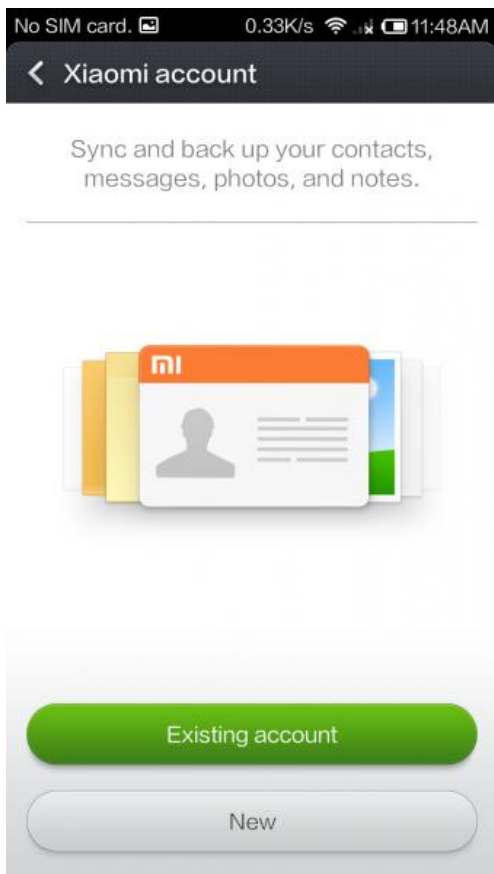

On the next screen you'll find MIUI's data usage monitor. This tool helps you to track your mobile data usage, provides alerts when you're in danger of exceeding your monthly limit, and can even automatically stop your phone from connecting Internet via SIM to prevent additional penalty charges. After you've configured the data monitor, you can choose whether or not you want to allow Xiaomi's built-in apps access your phone's location data (for maps, weather, etc.) and if you want to participate in Xiaomi's User experience program (send Xiaomi anonymous diagnostic and usage data).

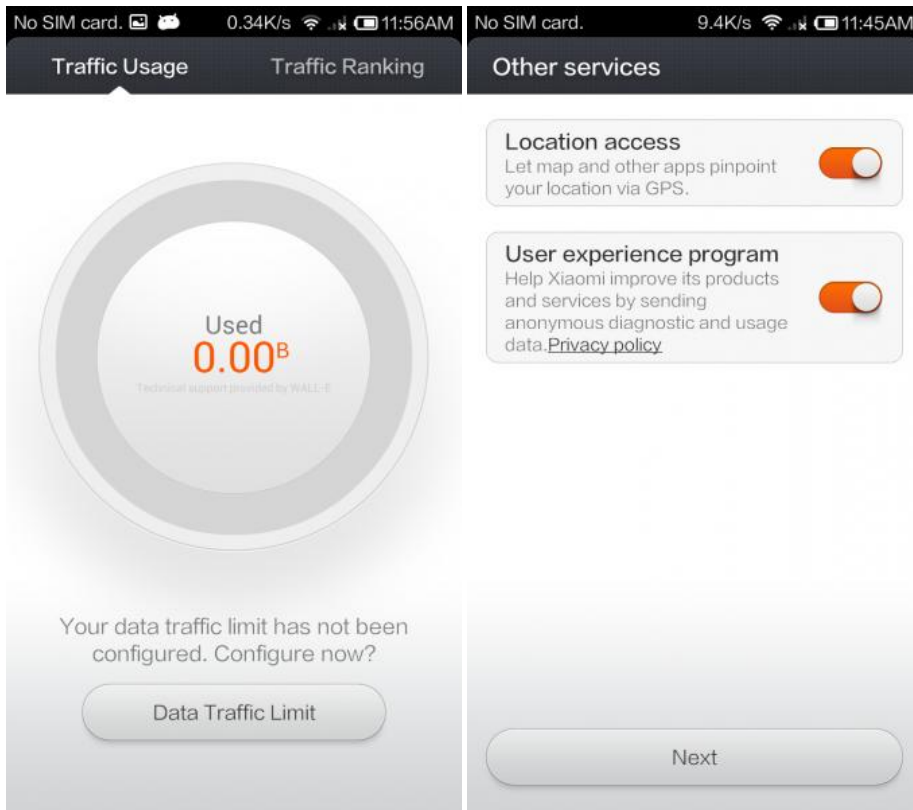

You're ready to start using MIUI!

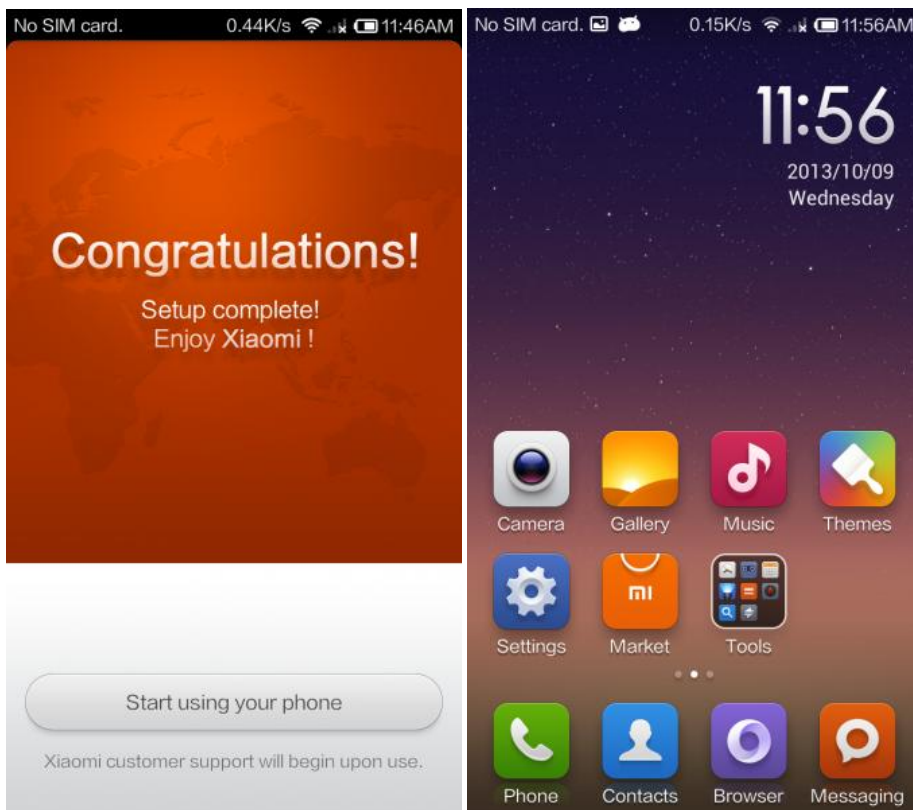

Importing contacts

First open Contacts. If you don't have any contacts, you will be presented the follow set of choices under the contacts tab: Sign in to an account, Import contacts from a file, Import from another phone, and Create a new contact.

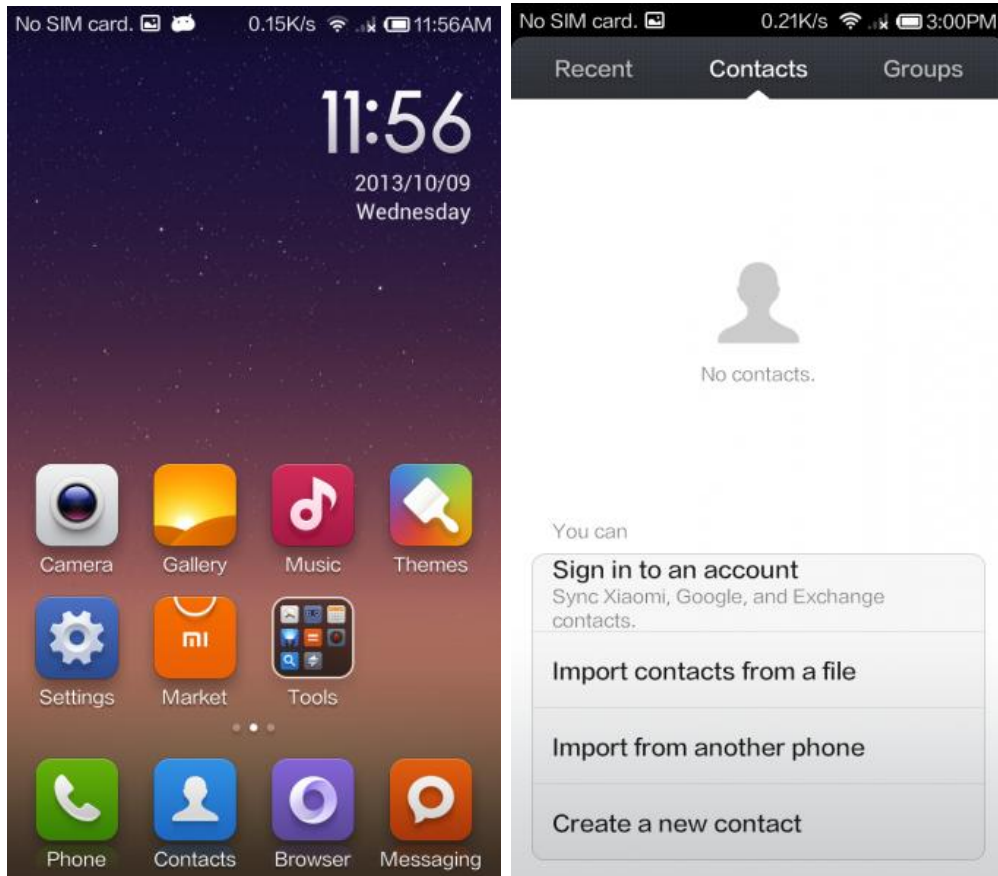

If you want to import contacts after you've already added a few, touch the Menu button and select Import/Export. From here, you can find detailed directions on how to import contacts from hundreds of different phones. Touch "Import from another phone" to get started.

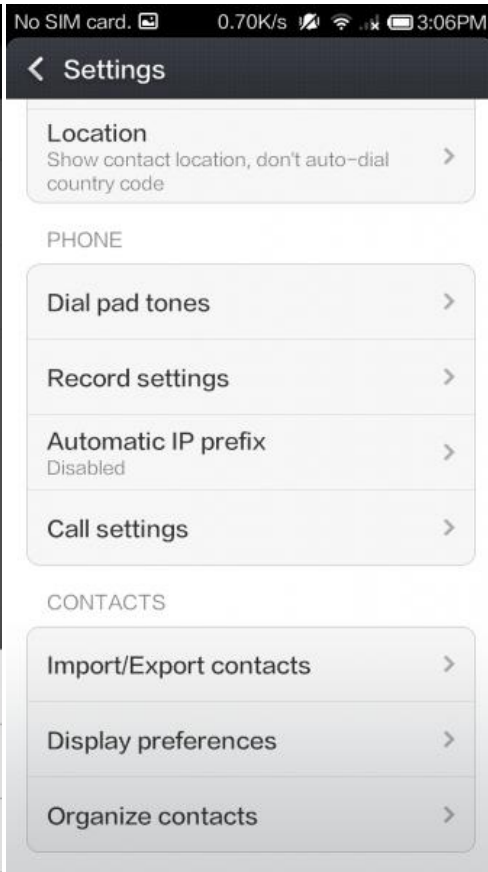
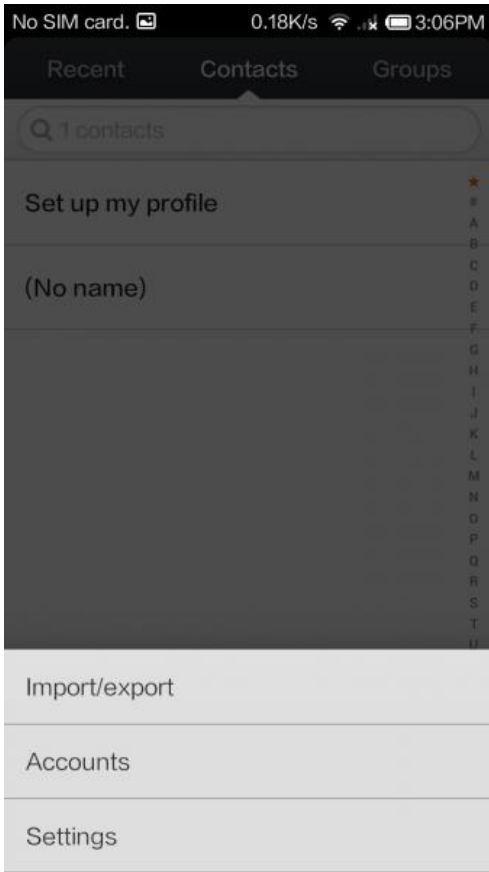

Browse & organize your Home screens

To move an app or widget, touch & hold it until the trash bin appears at the top of the screen, slide it into place, and lift your finger.



To edit an individual Home screen, pinch using two fingers (expand with two fingers to exit). You can also access this screen from the Settings menu (lower right screen shot).

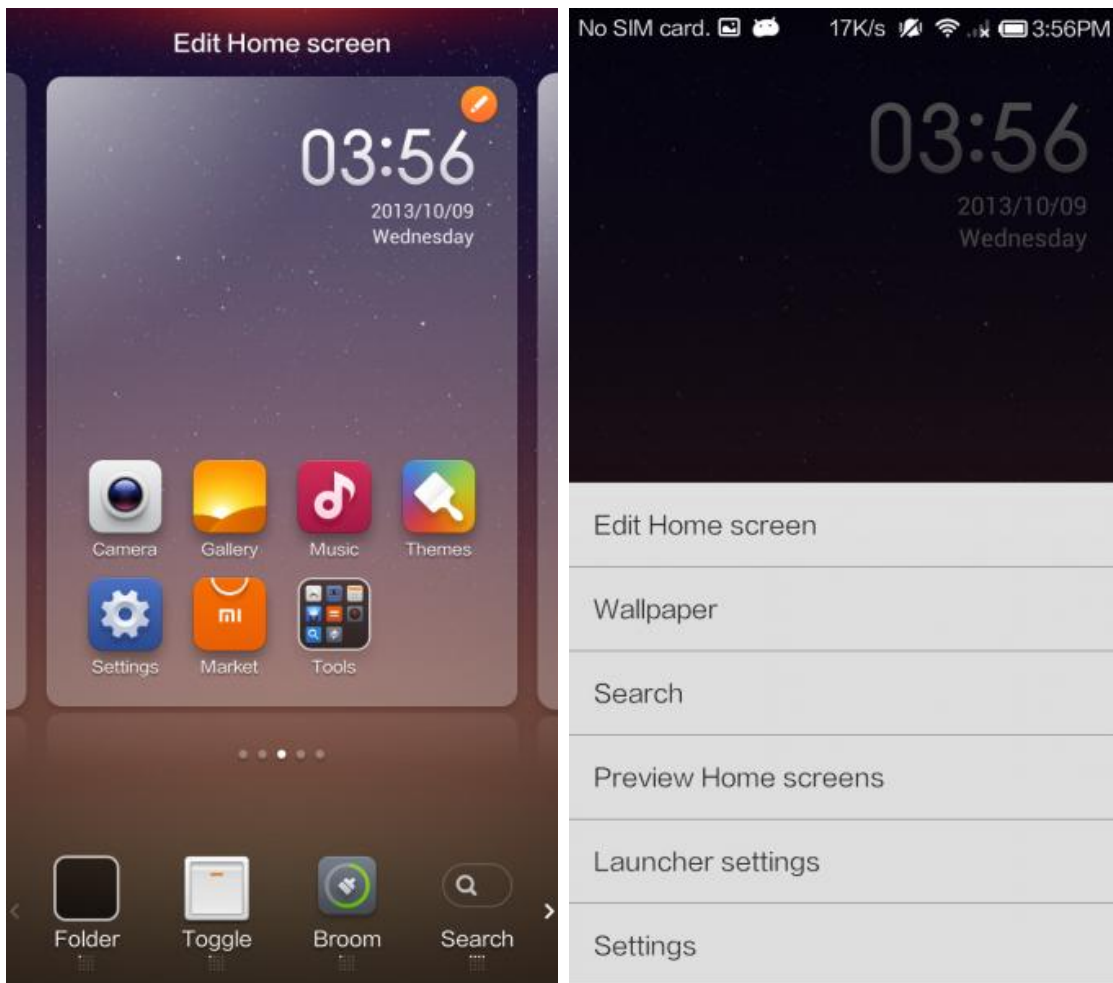

To preview all your Home screens, pinch using three fingers (touch any of the Home screens to exit). You can also access this screen from the Settings menu (see above right screen shot). To quickly change the order of your Home screens, touch & hold a Home screen to pick it up, lift your finger to drop it into place. Touch the Home icon to designate which screen you want to set as your default Home screen (i.e. Touch the Home button will bring you to this screen).

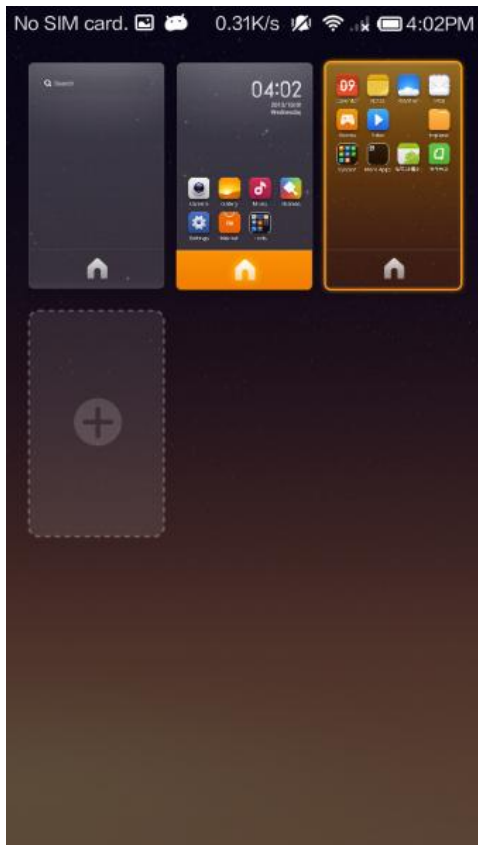
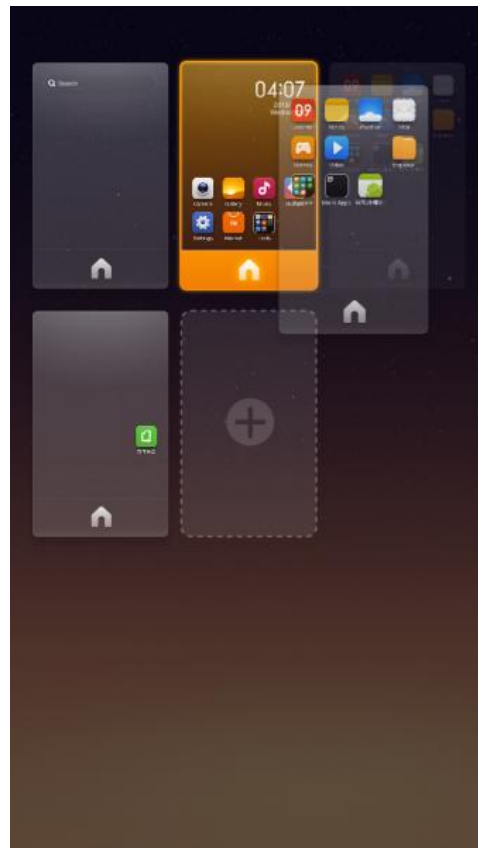
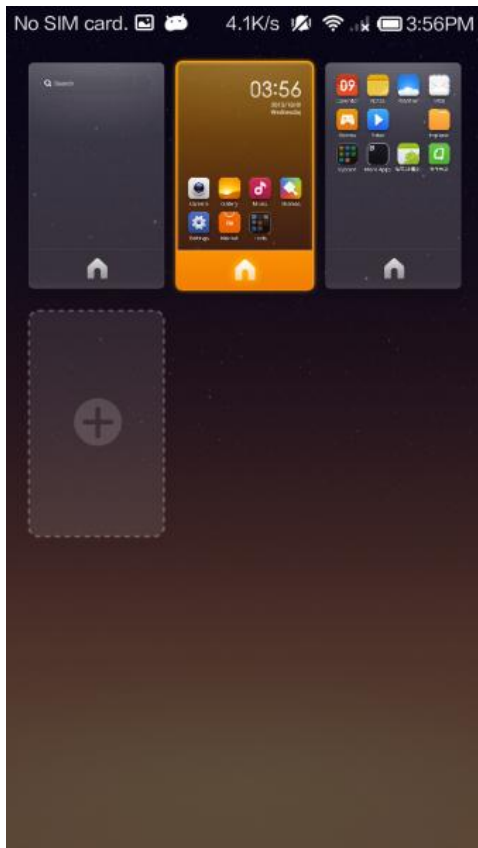

One final tip: To quickly tidy up the icons on a given Home screen, enter the edit Home screen mode (pinch using two fingers) and shake your phone three times. See the before (right) and after (left) below!



Getting Google apps and services

Unfortunately, a lot of Kingsoft's (a partner co. of Xiaomi) products and services are not available outside of mainland China and some of Xiaomi's services are a bit slow. Not to worry though, you can get all of your favorite Google products working on MIUI in no time!

Make sure you are running the latest Official Developer Build of MIUI (which you can find here <http://en.miui.com/download.html>). Then download the Google Installer (sets up the Google service framework, Play Store, and account manager) and the Google App Installer (both attached here >>).

<http://en.miui.com/forum.php?mod=attachment&aid=MzQzOTV8N2U1ZDg5N2R8MTQwOTgxOTU3MnwwfDg5OTA%3D>

<http://en.miui.com/forum.php?mod=attachment&aid=MzQzOTd8ZDg2ODQ3ZTB8MTQwOTgxOTU3MnwwfDg5OTA%3D>

Ok now open MIUI's built-in Permissions app > ROOT > Enable permissions manager

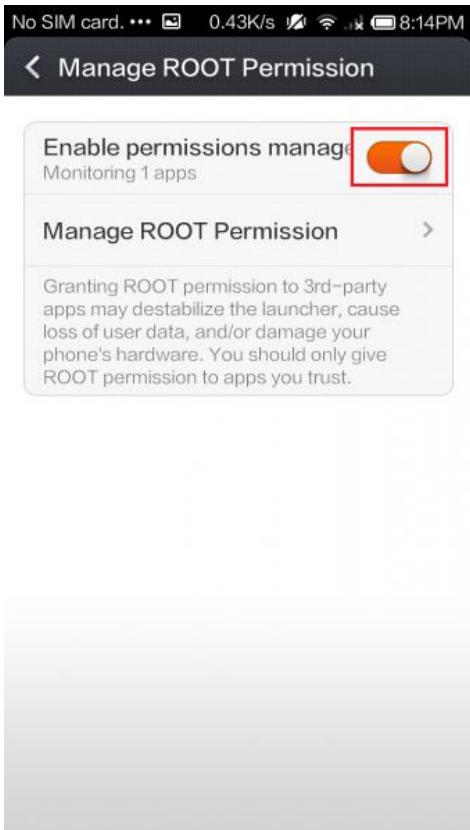
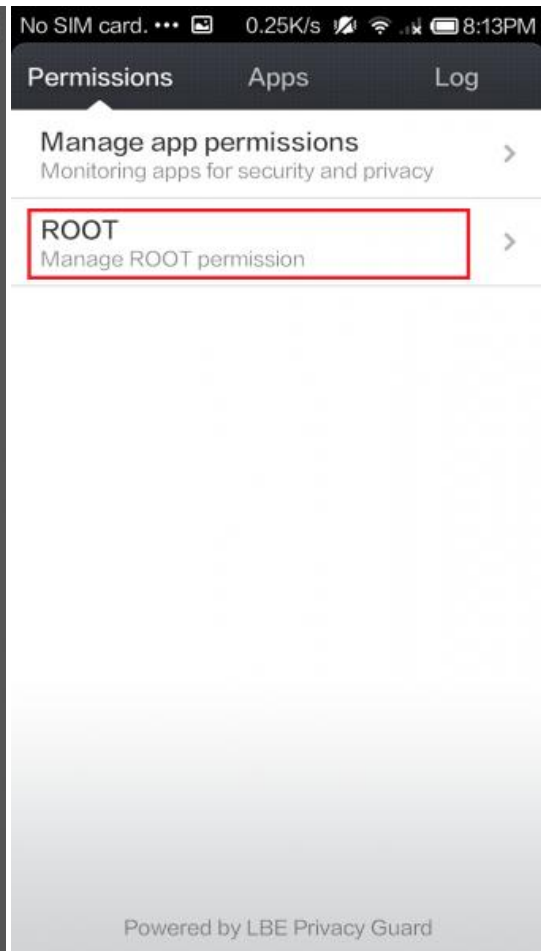
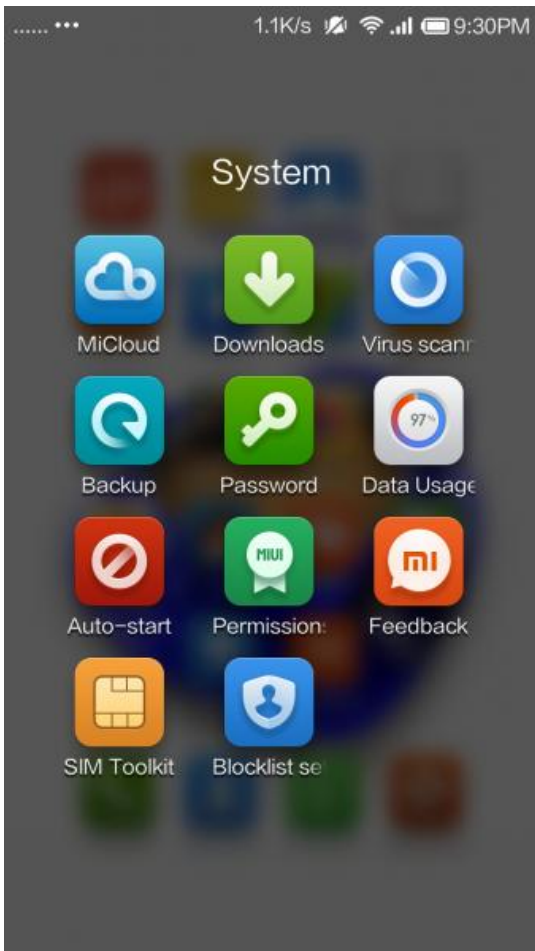

Next install the Google Installer (the lightning bolt logo with the 1.2 next to it). Touch the big blue button in the middle to start. Then, when MIUI warns you about granting Google app ROOT permissions check remember my decision and touch Next.

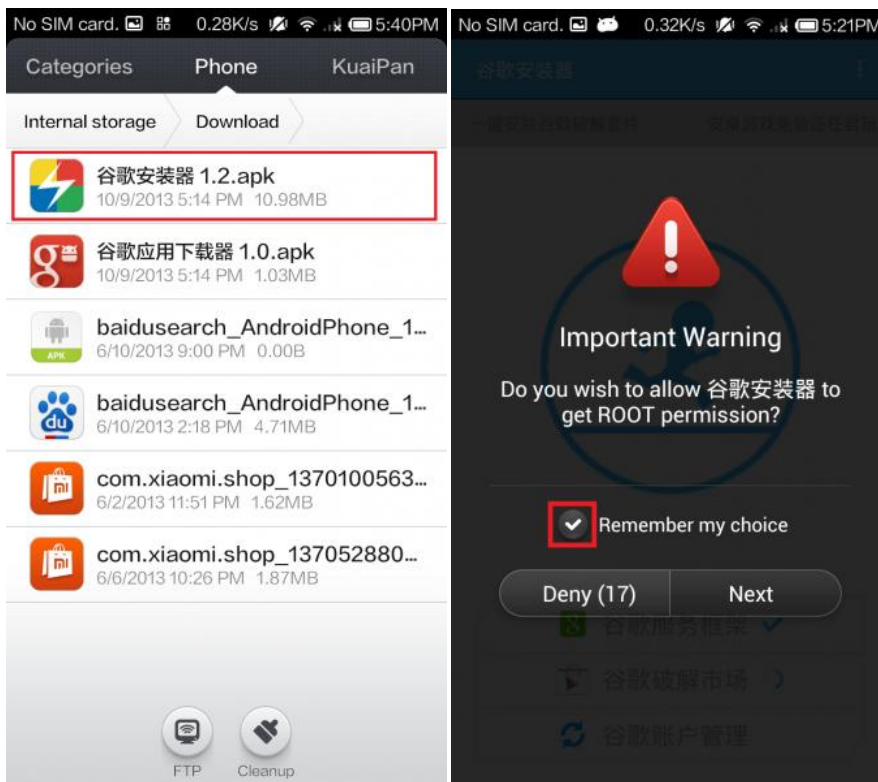
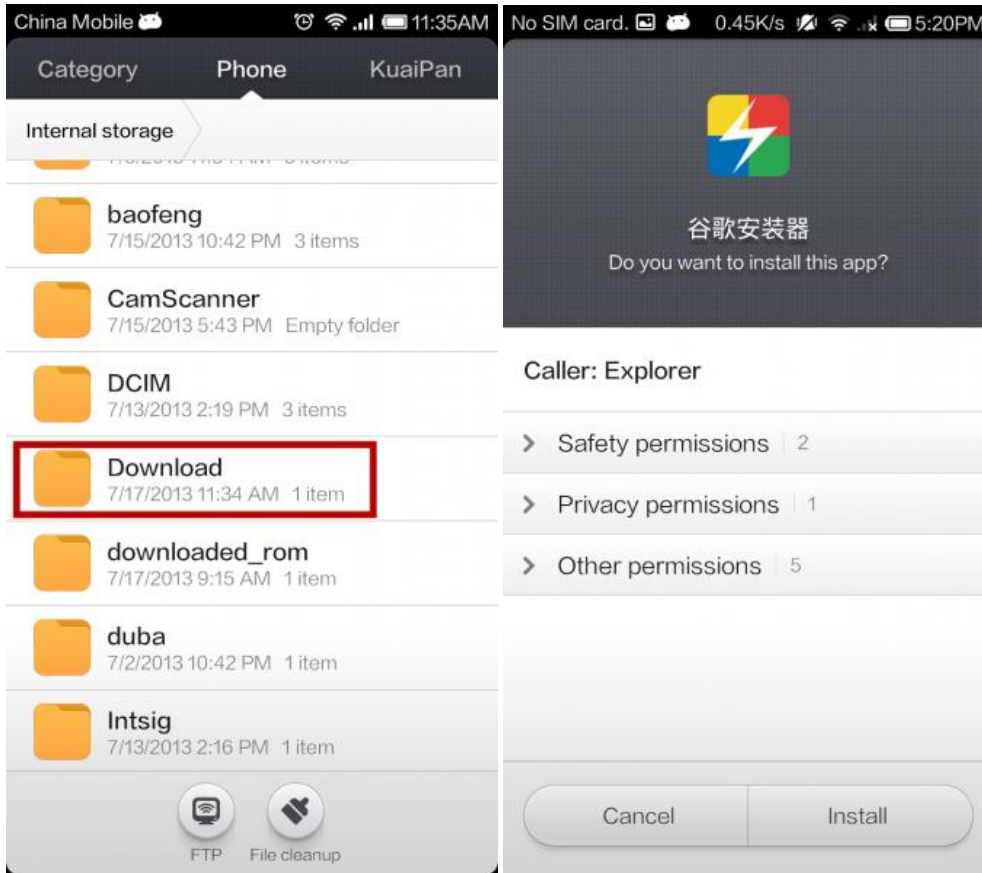

After installation process completes (the little running guy in the circle indicates the app is still installing), touch the big blue button in the middle to restart your phone (hint the characters 完成 are in the middle of the button!).



Ok moving on, set up your Google account in Settings > Accounts > Add Account > Google. (duh).

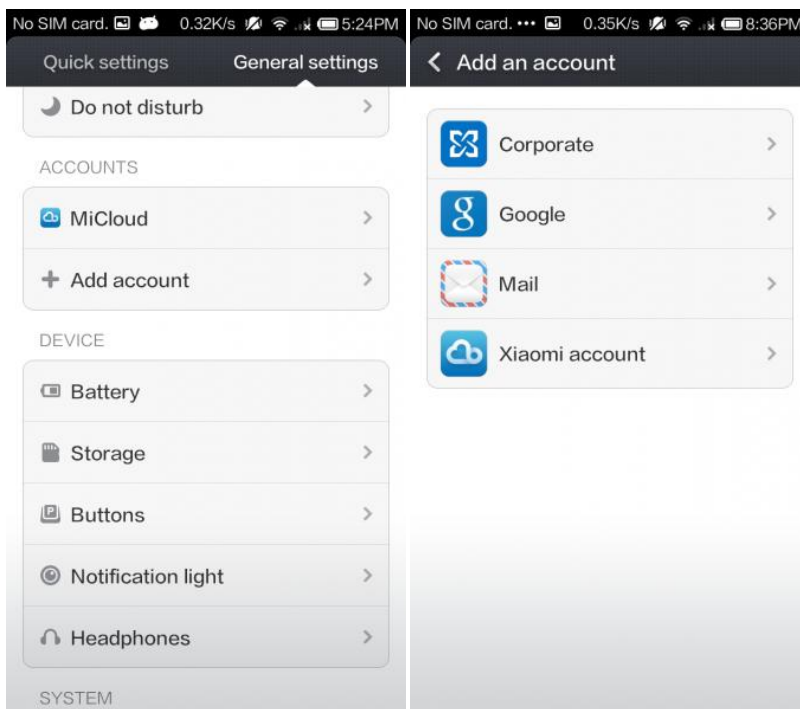

As you can see the Play Store is has appeared on the Home screen, but some of the sync features for Google products (like Calendar sync, Contacts sync) may still be unavailable. Don't panic. You can download them with the Google app installer (remember that second apk with the 1.0 next to it? go install it!). Open the Google installer (the red square with the white g), any app on the list with the characters “同步” indicates that is associated with syncing. Related sync functions for the Calendar and the Contacts app are in pictured in the red box below.



You can configure sync options in Settings > Accounts.

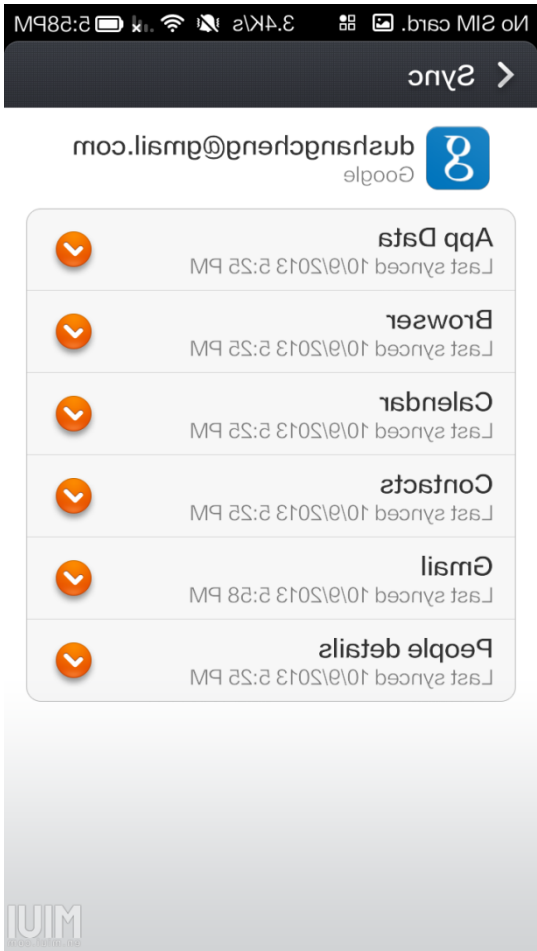

ENJOY!