

5. Exploded View and Parts List

5-1. Cellular phone Exploded View

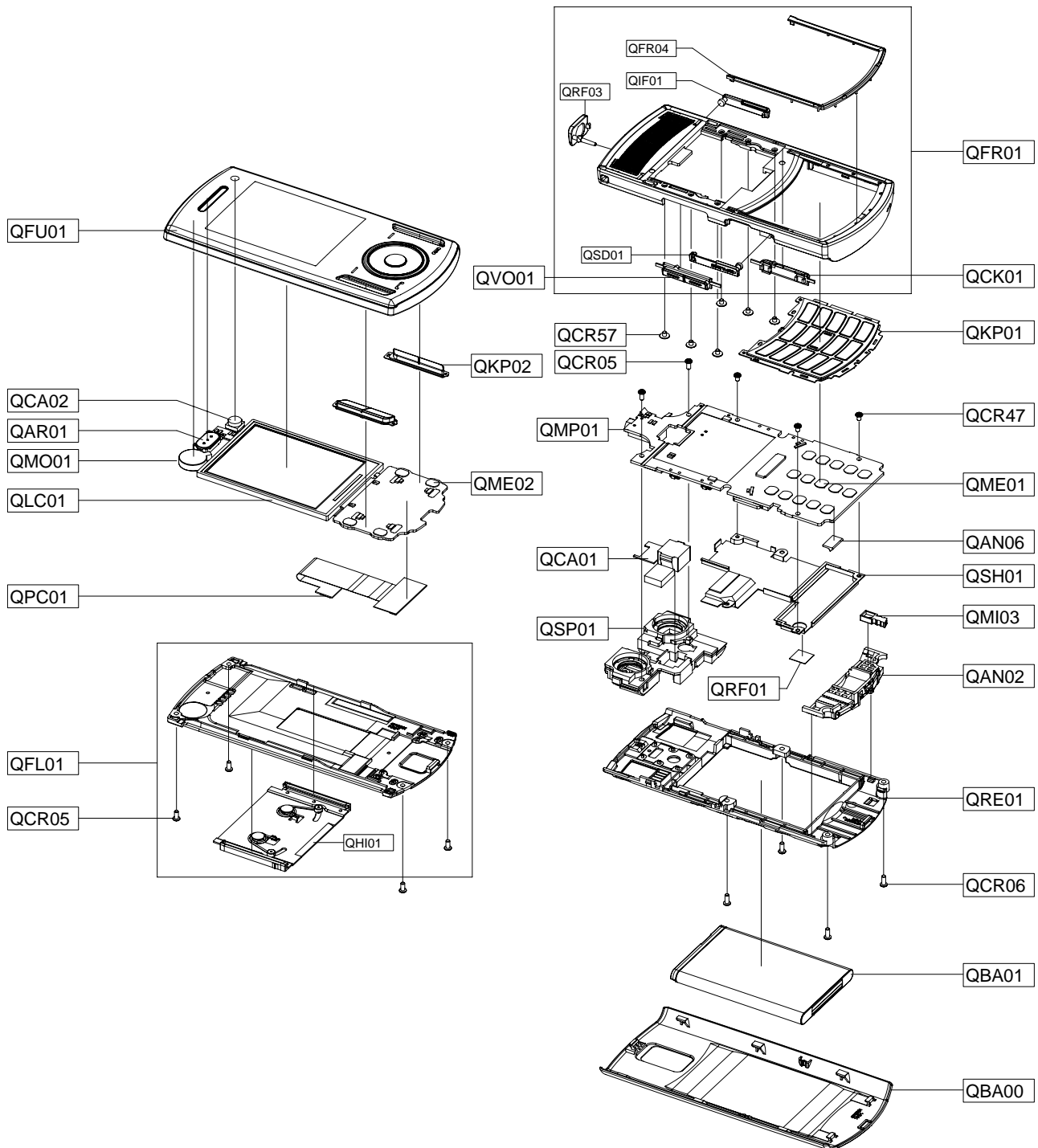

5-2. Cellular phone Parts list

Design LOC	Description	SEC CODE
QAN02	INTENNA-SGH-L770	GH42-01477A
QBA00	PMO COVER-BATTERY	GH72-45838E
QCA01	CAMERA MODULE-SGH-L770	GH59-05708A
QCA02	KEY FPCB-SIDE CAMERA KEY	GH59-05392A
QCK01	PMO KEY-CAMERA	GH72-45847B
QCR05	SCREW-MACHINE	6001-001478
QCR72	SCREW-MACHINE	6001-002051
QFL01	ASSY CASE-SLIDE LOWER	GH98-07227B
QFR01	ASSY CASE-FRONT	GH98-09018B
QFU01	ASSY CASE-SLIDE UPPER(OPEN/IS)	GH98-07224E
QHI01	ASSY HINGE-MODULE	GH98-07230A
QHI04	PMO COVER-HINGE CAP	GH72-45849A
QIF01	PMO COVER-IF	GH72-45844B
QKP02	ASSY CASE-SUB KEYPAD(OPEN)	GH98-07231A
QLC01	LCD-MODULE (SGH-L770)	GH07-01244A
QMP01	PBA MAIN-SGH_L770	GH92-04256A
QMW01	ASSY COVER-WINDOW MAIN(OPEN)	GH98-07225A
QPC01	FPC-SLIDE FPCB	GH41-02038A
QRE01	ASSY CASE-REAR	GH98-07232B
QRF01	ASSY COVER-RF	GH98-07840B
QSD01	PMO COVER-MICRO SD	GH72-45845B
QSH04	ASSY COVER-SHIELD FRONT	GH98-08144A
QSH05	ASSY COVER-SHIELD CAN REAR B	GH98-08968A
QSP01	ASSY ETC-SPK/MOT MODULE	GH59-05475A
QVK01	KEY FPCB-SIDE VOLUME KEY	GH59-05391A
QVO01	PMO KEY-VOLUME	GH72-45846B